

DG507A

Locator Map

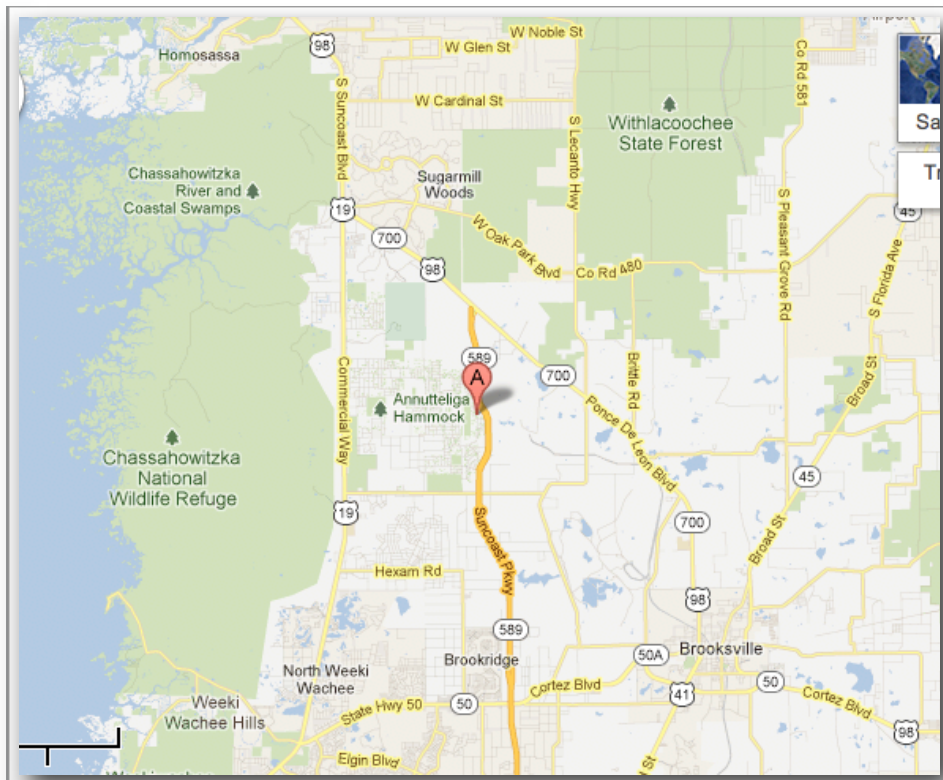
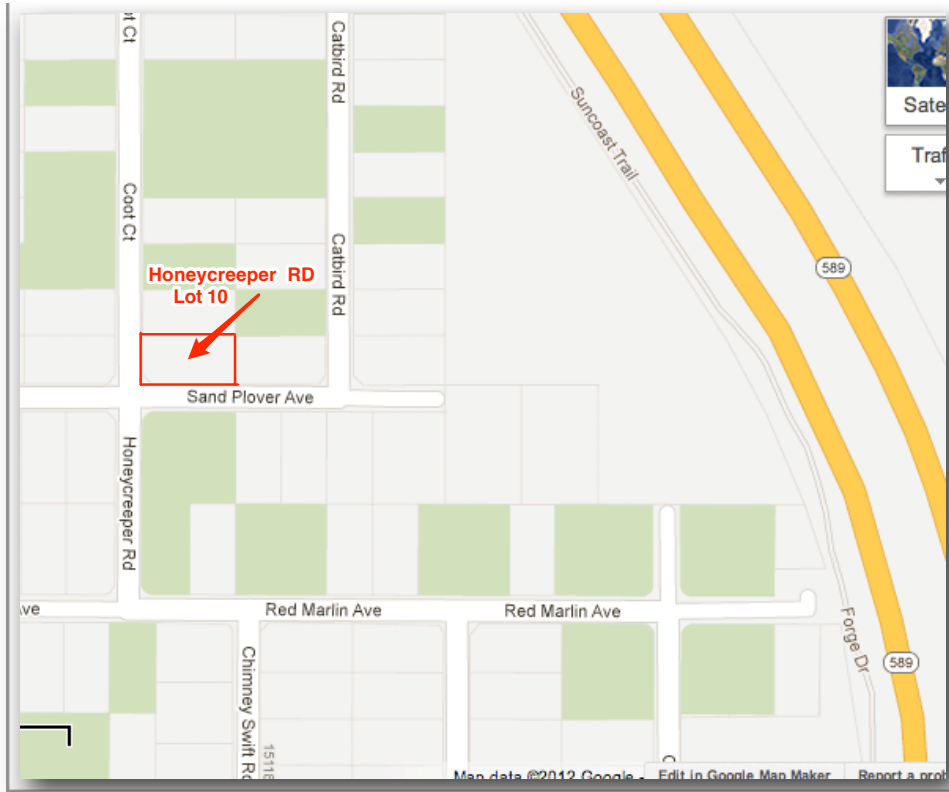

Hernando County Property Appraiser

CAMA updated: 9/21/2012

Parcel: **R01 221 17 3360 0760 0100** | KEY: **00815256**

2012 Preliminary Values

<< Next Lower Parcel # Next Higher Parcel # >>

TRIM Notice

Property Card

Interactive GIS Map

Print

Owner & Property Info

<< Prev Search Result: 2 of 2

Owner's Name(s)	RSST LLC		
Site	HONEYCREEPER RD (view all Site Addresses)		
First Owner's Mailing	170 US ROUTE 1 STE 195 FALMOUTH ME 04105-2155		
Brief Desc	ROYAL HIGHLANDS UNIT 8 BLK 760 LOT 10		
DOR Code (00) - Vacant Residential	Map Code 47D		
Levy Code CWES	GIS Code A094		
Land Use	Land Units		
RESIDENTIAL	20,914.00 SQUARE FEET		
TAX Information			
Tax History			
2011	\$149.56	TAX Links > Access real-time Tax info > Pay your Taxes on-line	
2010	\$186.63		
2009	\$209.24		
2008	\$372.81		

GIS Aerial

flown: Jan 2011

2011 | 2010 | 2009 | 2008 | 2007 | 2006 | 2005 | 2004



Property & Assessment Values

Land Value	\$4,392.00
Bldg Value	\$0.00
Features Value	\$0.00
Class Value	\$0.00
Limit Value	\$4,392.00

Assessed Value	\$4,392.00
Exempt Value	\$0.00
Excluded From Cap	\$0.00
Taxable Value	\$4,392.00
Just Mkt Value	\$4,392.00

Sales

Sale Date	OR Book/Page	OR Inst.Type	Sale V/I (Qual)	Sale Price	Sale Party
9/16/2011	2859/0257	QC	V (D)	\$100.00	RSST LLC
8/18/2011	2859/0255	QC	V (D)	\$100.00	CIRCLE B LLC
12/20/2010	2791/0764	CT	V (D)	\$100.00	SUNTRUST MORTGAGE INC
12/12/2005	2187/0917	WD	V (Q)	\$45,000.00	STILLERMAN WAYNE M
4/13/2004	1822/1903	WD	V (U)	\$22,800.00	SHARP ROBERT S & GERALDINE R
4/5/2001	1407/1234	TD	V (D)	\$1,000.00	RASHID ROGER A & CAROL A
11/1/1987	674/1005	TR	V (D)	\$4,800.00	GLIED GERHARD
5/1/1983	524/0023	WD	V (D)	\$4,733,000.00	BELOFF JONATHAN D TRUSTEE
1/1/1980	0/0000		(D)	\$0.00	ROYAL PALM BCH COLONY INC

Building Characteristics

Bldg #	Bldg Desc	Year Blt	Area (Base / Aux)	Bed / Bath
NONE				

Extra Features & Out Buildings

Description	Actual Year	Dimensions	Dep. Cost
NONE			

Address Listings

0 HONEYCREEPER RD			
-------------------	--	--	--

Business Listings

--

NONE

Mobile Homes and Lease Accounts

NONE

Hernando County Property Appraiser - Roll Year: 2012

CAMA updated: 9/21/2012

<< Prev

Search Result: 2 of 2

This information was derived from data which was compiled by the Hernando County Property Appraiser's Office solely for the governmental purpose of property assessment. This information should not be relied upon by anyone as a determination of the market value, ownership, or zoning of the property. Zoning information should be obtained from the Hernando County Development Department. No warranties, expressed or implied, are provided for the accuracy of the data herein, it's use, or it's interpretation. Although it is periodically updated, this information may not reflect the data currently on file in the Property Appraiser's office. The assessed values are NOT certified values and therefore are subject to change before being finalized for ad valorem assessment purposes.

© Copyright 2003 All Rights Reserved - Hernando County Property Appraiser

R01 221 17 3360 0760 0100 (LT:10)
RSST LLC
12/12/2005 - \$45,000 - V/Q

▲ NORTH ▲

▲ WEST ▲

▲ EAST ▲

▼ SOUTH ▼

EEPER RD

IBIRD RD

SAND PLOVER AVE

SAND PLOVER AVE

EPER RD



DG507B Locator Map

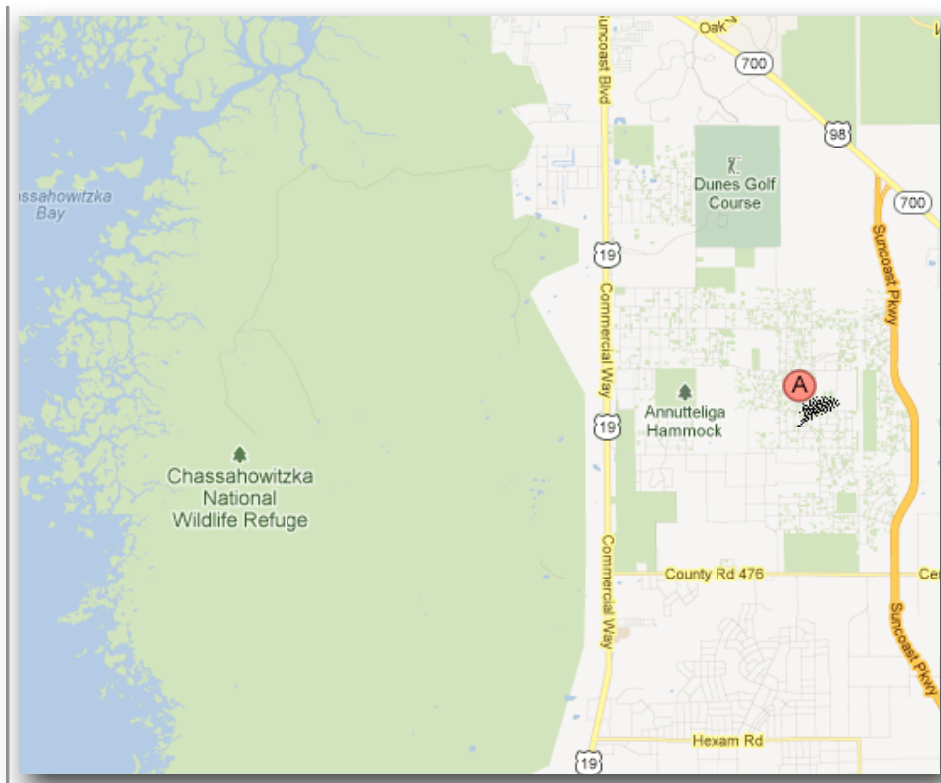
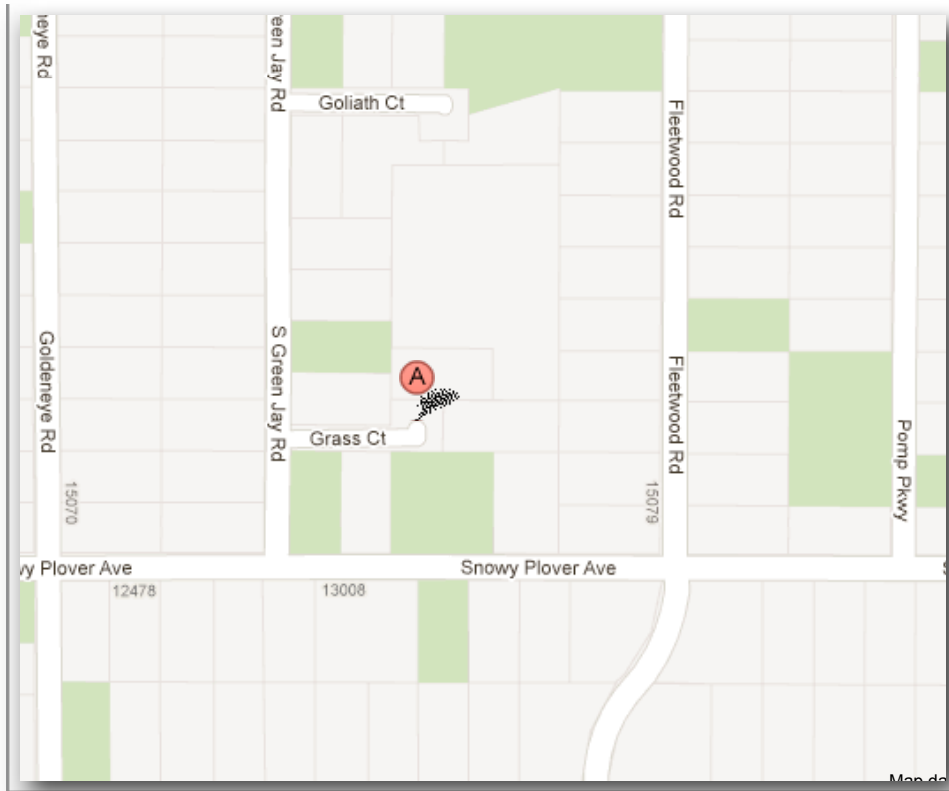

Hernando County Property Appraiser

CAMA updated: 9/21/2012

Parcel: **R01 221 17 3357 4630 0250** | KEY: **00761964**

<< Next Lower Parcel # Next Higher Parcel # >>

2012 Preliminary Values

TRIM Notice

Property Card

Interactive GIS Map

Print

Owner & Property Info

Search Result: 1 of 2 Next >>

Owner's Name(s)	ROYAL LOTS LLC	
Site	GRASS CT	(view all Site Addresses)
First Owner's Mailing	125 SABBADY POINT RD WINDHAM ME 04062-5507	
Brief Desc	ROYAL HIGHLANDS UNIT 7 BLK 463 LOT 25	
DOR Code (00) - Vacant Residential	Map Code 47C	
Levy Code CWES	GIS Code A093	
Land Use	Land Units	
RESIDENTIAL	20,000.00 SQUARE FEET	
TAX Information		
Tax History		TAX Links > Access real-time Tax info > Pay your Taxes on-line
2011	\$136.91	
2010	\$157.40	
2009	\$203.05	
2008	\$359.45	

GIS Aerial

flown: Jan 2011

2011 | 2010 | 2009 | 2008 | 2007 | 2006 | 2005 | 2004



Property & Assessment Values

Land Value	\$3,800.00
Bldg Value	\$0.00
Features Value	\$0.00
Class Value	\$0.00
Limit Value	\$3,800.00

Assessed Value	\$3,800.00
Exempt Value	\$0.00
Excluded From Cap	\$0.00
Taxable Value	\$3,800.00
Just Mkt Value	\$3,800.00

Sales

Sale Date	OR Book/Page	OR Inst.Type	Sale V/I (Qual)	Sale Price	Sale Party
11/15/2011	2868/1522	QC	V (D)	\$800.00	ROYAL LOTS LLC
6/21/2011	2858/1001	QC	V (D)	\$100.00	MALTON LLC
2/17/2010	2720/0880	CT	V (D)	\$100.00	BRANCH BANKING AND TRUST COMPA
6/2/2006	2275/0942	WD	V (Q)	\$52,000.00	MATTSON HAROLD
9/3/2004	1900/0837	WD	V (Q)	\$11,500.00	FORRESTER ARLENE & KENMORE
2/1/1990	770/0174	WD	V (Q)	\$4,500.00	MANSFIELD MAYNARD & JANET
7/1/1988	702/0998	TR	V (M)	\$34,000.00	ROYAL T LAND INC
5/1/1983	524/0023	WD	V (D)	\$4,733,000.00	BELOFF JONATHAN D TRUSTEE
1/1/1980	0/0000		(D)	\$0.00	ROYAL PALM BCH COLONY INC

Building Characteristics

Bldg #	Bldg Desc	Year Blt	Area (Base / Aux)	Bed / Bath
NONE				

Extra Features & Out Buildings

Description	Actual Year	Dimensions	Dep. Cost
NONE			

Address Listings

0 GRASS CT			
------------	--	--	--

Business Listings

--

NONE

Mobile Homes and Lease Accounts

NONE

Hernando County Property Appraiser - Roll Year: 2012

CAMA updated: 9/21/2012

Search Result: 1 of 2

Next >>

This information was derived from data which was compiled by the Hernando County Property Appraiser's Office solely for the governmental purpose of property assessment. This information should not be relied upon by anyone as a determination of the market value, ownership, or zoning of the property. Zoning information should be obtained from the Hernando County Development Department. No warranties, expressed or implied, are provided for the accuracy of the data herein, it's use, or it's interpretation. Although it is periodically updated, this information may not reflect the data currently on file in the Property Appraiser's office. The assessed values are NOT certified values and therefore are subject to change before being finalized for ad valorem assessment purposes.

© Copyright 2003 All Rights Reserved - Hernando County Property Appraiser



20-21S-18E

21-21S-18E

GOLDENEYE RD

SNOWY OWL AVE

FLEETWOOD RD

POMP PKWY

ENGLISH SPARROW RD

SPRUCE GROUSE AVE

GRASS CT

GONZO RD

SNOWY PLOVER AVE

SNOWY PLOVER AVE

ENGLISH SPARROW RD

GBIRD RD

TRAPPER JOHN RD

TRAPPER JOHN RD

RD

RD